

## STEERING WHEEL

### User Manual

Please read the manual carefully before using the product, and keep this manual for future reference.

#### ⚠ WARNING — Electrical Safety

- \* Please connect, install and remove this product with proper force, don't twist or pull the connectors and interface.
- \* Avoid getting water or other liquids on product or its connectors.
- \* Please keep the product in dry place and keep away from fire, don't expose the product in humid conditions, high temperature or a dusty environment.
- \* Please use the power cables provided with the base, do not use other power cables.
- \* Please don't use the power cable if the cable or its connector is damaged, cracked, or broken.
- \* Make sure that the power supply cable is properly plugged into the steering wheel's base.
- \* Please don't disassemble, refit or repair on your own. Any repairs must be carried out by the manufacturer, the authorized representatives or qualified technicians.
- \* Please use the attached system/ accessories specified by manufacturer only.
- \* If any unusual sound, heat or odor occurs with this product, please stop using it.

#### ⚠ WARNING — Possible injuries caused by force feedback and repetitive movements

To avoid any accident, please take below advice for reference:

- \* Avoid lengthy gaming periods.
- \* Take a break of 10 to 15 minutes after each hour of using this product.
- \* If you feel any fatigue or pain in your hands, wrists, arms, feet or legs, please stop playing and rest for a few hours. If the symptoms or pain indicated persist, please stop playing and consult the doctor.
- \* Please keep out of children's reach.
- \* During gameplay, please always keep your hands in the steering wheel in the correct position, not placed at random.
- \* During gameplay, please never place your hands or your fingers under the pedals or anywhere near the pedal set.
- \* During calibration and gameplay, please never place your hands or your arms through the openings in the steering wheel.



ALWAYS



NEVER



NEVER

The product can only be operated by users aged 16 or above.

#### ⚠ Heavy Product

Be careful not to drop the product on yourself or on anyone else !

## ENGLISH

### 01 System Requirement

Supported platform: PC, PS4, X-ONE, X-SERIES X|S  
Base Requirement: PXN-V12DDS Base

### 02 Package Content



PXN-V12CW \*1

### 03 Installation

\* The steering wheel needs to be used with PXN Base

- Step 1 Align the top 6 steel balls and bottom 4 steel balls of steering wheel with the corresponding notches on the base's quick release.
- Step 2 Press the gold part of the quick release to the steering wheel plate.
- Step 3 Push the steering wheel towards the base and release the gold part of the quick release. The quick release will be automatically locked up.

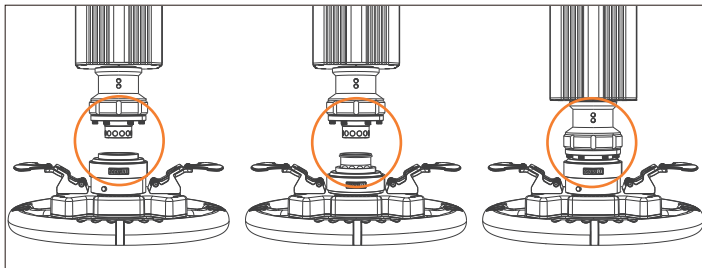

If you want to remove the steering wheel plate, press the gold part of quick release and pull out the steering wheel.

Note: After installation, please try to pull the steering wheel back to ensure that the steering wheel is firmly installed. If it is not securely installed, turn the steering wheel around or remove it and reinstall it and repeat the checking.

### 04 High Configuration Setting

Download the APP [ PXN Wheel ] for high configuration settings.

APP Function Introduction :  
Button mapping setting of steering wheel  
Game preset button configuration  
Button testing of steering wheel



Scan to download the APP

### 05 Attention

- Please read this user manual carefully before using the product.
- Avoid strong shocks or vibration and do not drop.
- Do not disassemble, modify and repair by yourself.
- Prevent water or other liquids from entering the product to avoid damage.
- Avoid storing in humid, high temperature, oily smoke and other places.
- Please handle it gently when connect and remove the product.
- Children should be under adult's supervision at all times when using this product.

### 06 Product Specifications

Model	PXN-V12CW
Connection Method	Quick Release System
Power Supply Type	Wireless Power Supply
Signal Transmission	Wireless Transmission
Package Size	About 410 * 394 * 174 mm
Product Size	About 328 * 328 * 112 mm
Product Weight	About 2485 g
Use Temperature	10-40 °C
Use Humidity	20~80 %

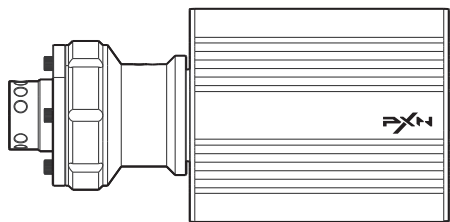

## DIRECT DRIVE SERVO BASE

### User Manual

Please read the manual carefully before using the product, and keep this manual for future reference.

#### ⚠ Warning — Electrical Safety

- \* Please connect, install and remove this product with proper force, don't twist or pull the connectors and cables.
- \* Avoid getting water or other liquids on product or its connectors.
- \* Please keep the product in dry place and keep away from fire, don't expose the product in humid conditions, high temperature or a dusty environment.
- \* Please use the power cables provided with the base, do not use other power cables.
- \* Please don't use the power cable if the cable or its connector is damaged, cracked, or broken.
- \* Make sure the power supply cable is properly plugged into the power outlet and properly connected to the connector on the back of the steering wheel base.
- \* Please don't disassemble, refit or repair on your own. Any repairs must be carried out by the manufacturer, the authorized representatives or qualified technicians.
- \* Please use the attached system/ accessories specified by manufacturer only.
- \* If any unusual sound, heat or odor occurs with this product, please stop using it and disconnect the power cable from the power outlet and cut off other cables.
- \* If the product is not used for a long time, please disconnect the power cable from the power outlet, which must be located near the product and must be easy to plug and unplug the power cable.

#### ⚠ Warning — Possible injuries caused by force feedback and repetitive movements

To avoid any accident, please take below advice for reference:

- \* Avoid lengthy gaming periods.
- \* Take a break of 10 to 15 minutes after each hour of using this product.
- \* If you feel any fatigue or pain in your hands, wrists, arms, feet or legs, please stop playing and rest for a few hours before playing again.
- \* If the symptoms or pain indicated persist when you start playing again, please stop playing and consult your doctor.
- \* Please keep out of children's reach.
- \* Ensure that the steering wheel base is secured according to the instructions in this manual.

#### Ventilation

Make sure not to block any of the air vents on the steering wheel base. For optimal ventilation, please make sure to do the following:  
\* Keep the steering wheel base at least 10cm away from any wall.  
\* Do not place the base in any confined space.  
\* Do not cover the base.  
\* Do not let any dust build up on the air vents.

#### Temperature

- \* If the device's temperature becomes too high(60°C and above) due to ventilation, environment, usage or other reasons, the base motor will automatically reduce the output power.
- \* If the device's temperature becomes too high(70°C and above) due to ventilation, environment, usage or other reasons, the base motor will automatically power OFF.
- \* Do not touch any part of the motor when the output power of the base motor is reduced or power OFF due to high temperature.

The product can only be operated by users aged 16 or above.

#### ⚠ Heavy Product

Be careful not to drop the product on yourself or on anyone else !

#### ⚠ Automatic Calibration

The steering wheel will automatically calibrate after successful connection and power ON. During calibration, the motor will rotate quickly towards the left and the right before stopping at the center.

If the product do not operate correctly, or if calibration seems incorrect :

Turn off the game console/PC and disconnect your steering wheel entirely. Then reconnect all cables and accessories as well as restart the console or PC and then enter the game again.

## ENGLISH

### 01 System Requirement

Supported platform: PC, PS4, X-ONE, X-SERIES X|S

System requirement on PC: Windows 7 / 8 / 10 / 11

Note: Original controller should be used for guidance while playing on PS4 and X-ONE / X-Series X|S platforms.

Steering wheel requirement: PXN-V12CW steering wheel

### 02 Back Interface of Wheel Base

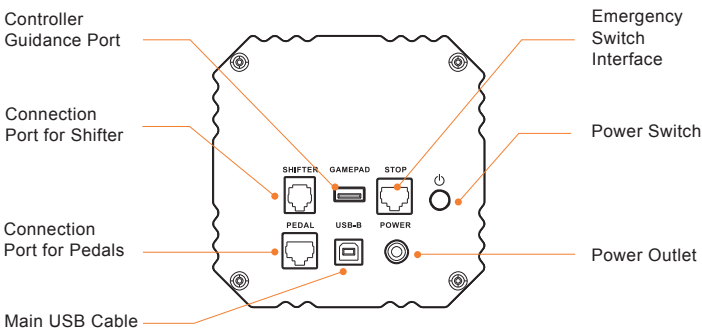

### 03 Product Contents

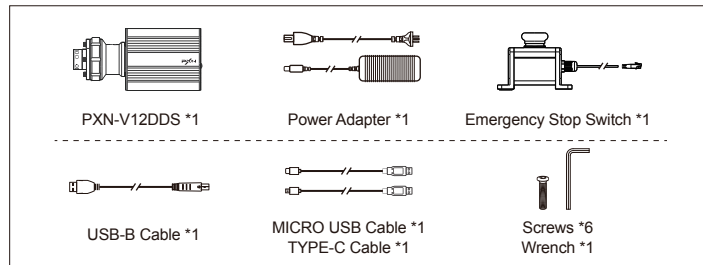

### 04 Installation

The steering wheel base should be equipped with the brackets or steering seat that can lock screws and stabilize the load.

- Step 1 Place the base in the proper position and align the bottom screw hole with the mounting hole.
- Step 2 Use the Allen wrench to tighten the screws.
- Step 3 Align the top 6 steel balls and bottom 4 steel balls of steering wheel with the corresponding notches on the base's quick release first. Then press the quick release gold part towards the panel and then release. The automatic locking installation is completed at this time.

### 05 Connect with PC

\* This product needs to be used with the PXN racing wheel.

- Step 1 Install the PXN racing wheel to the base properly as required.
- Step 2 Connect the base to the power adapter for power supply.
- Step 3 Use the USB-B cable to connect the base to the USB port on the PC.
- Step 4 Press the power switch on the back of the base and the racing wheel will self-test and return to the center.
- Step 5 After successful connection, the racing wheel RGB light will be on red by default.

### 06 Connect with PS4

\* This product needs to be used with the PXN racing wheel.

- Step 1 Before connecting, please make sure the PS4 console is ON and the PS4 original controller is OFF. (Long press the PS button on the controller until the controller LED is off to turn it off)
- Step 2 Connect the base to the power adapter for power supply.
- Step 3 Use the Micro USB cable to connect the PS4 original controller to the controller guidance port on the back of the base.
- Step 4 Use the USB-B cable to connect the base to the USB port of the PS4 console.
- Step 5 Press the power switch on the back of the base, and the racing wheel will self check and return to the center.
- Step 6 Press the PXN button on the racing wheel to the console user page, then press the [X] button on the wheel to identify the user and control the console, the racing wheel RGB blue light is always ON by default after the successful connection.

### [ PS4 Connection Diagram ]

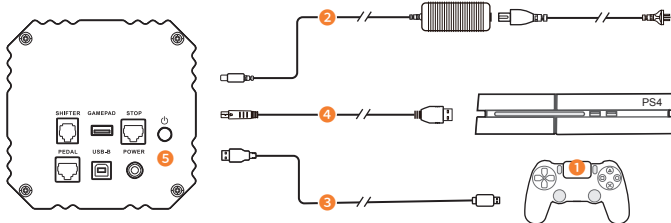

### 07 Connect with X-ONE / X-SERIES X|S

\* This product needs to be used with the PXN racing wheel.

- Step 1 Before connecting, please make sure the Xbox console is ON and the Xbox original controller is OFF. (Long press the Xbox button on the controller and select Turn OFF controller on the console)
- Step 2 Connect the base to the power adapter for power supply.
- Step 3 Use the Micro USB cable/ Type-C cable to connect the Xbox original controller to the controller guidance port on the back of the base.
- Step 4 Use the USB-B cable to connect the base to the USB port of the Xbox console.
- Step 5 Press the power switch on the back of the base, and the racing wheel will self check and return to the center.
- Step 6 Press the PXN button on the racing wheel to the console homepage, the racing wheel RGB green light is always ON by default after the successful connection.

### [ XBOX Series X Connection Diagram ]

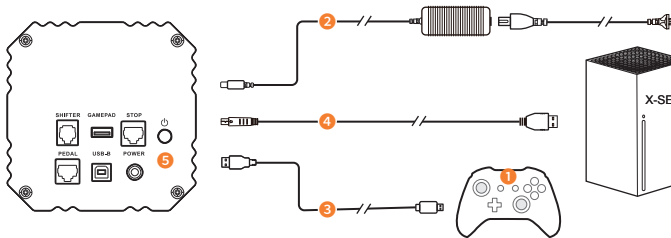

### 08 High Configuration Setting of Base

Download the APP [ PXN Wheel ] on the mobile phone to explore the high configuration settings of base.

APP Function Introduction:  
Base effective rotation degree setting  
Adjustment of force feedback value of the base  
Function testing of the base



Scan to download the APP

### 09 Emergency Stop Switch

\* Please confirm the Emergency Stop Switch has been released before using

- Step 1 Fix the Emergency Stop Switch within the reach of both hands and connect it to the STOP interface on the back of the base.
- Step 2 Press the Emergency Stop Switch to cut off the motor of the base in case of emergency during using.
- Step 3 Turn the Emergency Stop Switch button clockwise to release. Any part of your body should not be close to the base at this time.

Press to emergency stop:

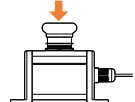

Rotate to release:

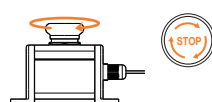

### 10 Attention

- Please read this user manual carefully before using the product.
- Avoid strong shocks or vibration and do not drop.
- Do not disassemble, modify and repair by yourself.
- Prevent water or other liquids from entering the product to avoid damage.
- Avoid storing in humid, high temperature, oily smoke and other places.
- Please handle it gently when connect and remove the product.
- Children should be under adult's supervision at all times when using this product.

### 11 Product Specifications

Model	PXN-V12DDS
Connection Method	USB Wired Cable
Power Supply	Working Power: 36V
Working Current	Max. Working Current: 10A
Package Size	About 410 * 394 * 191 mm
Product Size	About 125 * 125 * 258 mm
Product Weight	About 6315 g
Use Temperature	10-40 °C
Use Humidity	20~80 %