

Thank you for choosing and supporting PXN, please read this manual carefully before starting to enjoy your gaming experience.

## 01 - Product Overview

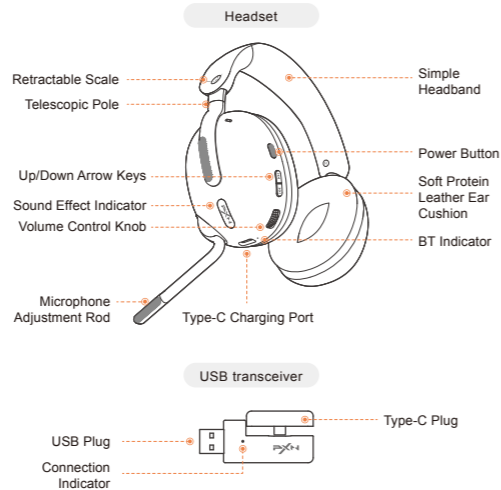

## 02 - Power ON/OFF

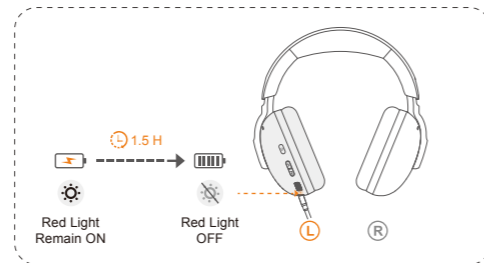
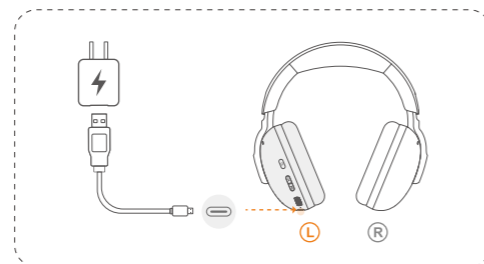

## 03 - Headset Charging



Hold and press the "⏻" power button\* for about 3 seconds to turn it on, the blue light will turn on for 2 seconds and then start flashing. Hold and press the "⏻" power button\* for about 5 seconds to turn it off, the blue light will turn on for 2 seconds and then turn off.

## 04 - BT Connection

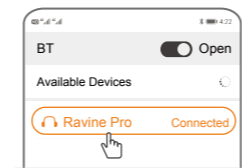

For the first time using, the headset will automatically enter pairing mode and you will hear the prompt "Pairing" after turning it on. Then, check your BT pairing list on the phone to find "Ravine Pro" and connect to it. Once connected, you will hear the prompt "Connected" and the blue indicator will flash every 10 seconds.

## 05 - 2.4G Connection

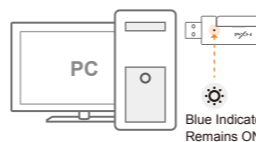

After plug the transceiver into your PC, console, or mobile device, the headset will automatically connect after turning it on. When the headset are connected, you will hear the prompt "Connected" and the transceiver's blue light will remain on. The blue indicator light on the headset will flash every 10 seconds.

## 06 - Forced Pairing

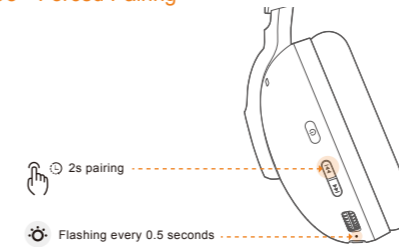

If you need to connect the headset to another device after using them with one device for more than 5 minutes, press and hold the up arrow button for 2 seconds to enter forced pairing mode. The blue indicator light on the headset will flash every 0.5 seconds.

## 07 - Button Functions

Main Control Functions	Button Functions	Gesture
Power ON	Press and hold the power button when the headset is under OFF state	⏻ 3s
Power OFF	Press and hold the power button when the headset is under ON state	⏻ 5s
Play/Pause	Press the power button once	⏻ x1
Answer/Hang up calls	Press the power button once	⏻ x1
Reject calls	Hold and press the power button	⏻ 1s
Previous track	Press the up arrow button once	⏪ x1
Next track	Press the down arrow button once	⏩ x1
Volume up/down	Moving the volume knob upwards increases the volume Moving the volume knob downwards decreases the volume	⏮ + ⏭ -
Music mode (green light) Game mode (blue light) Movie mode (ice blue light)	Double-click the down arrow button to switch to another sound effect You will hear a prompt when the sound effect has been changed	⏩ x2
ANC mode Transparent mode Normal mode	Double-click the up arrow button to switch to another working mode You will hear a prompt when the mode has been changed	⏮ x2
Microphone on/off	Pull down to open/Pull back to close You will hear a prompt when it switches on and off	📞
Forced pairing	Hold and press the up arrow button You will hear a prompt	⏪ 2s
LED light on/off	To turn off the light, press and hold the down arrow key To turn on the light, press and hold the down arrow key once more	⏩ 2s

## 08 - How to Wear



## 09 - Product Specifications

Product Name	Ravine Pro
BT Version	BT 5.3
BT Protocol	A2DP AVRCP HFP HSP
Audio Decoding	SBC AAC
Driver	40mm composite diaphragm speaker
Frequency Response	20Hz-20KHz
Sensitivity	94dB
Effective Range	≥10m
Battery Type	Lithium battery
Battery Capacity	800mAh
Input Voltage	5V/600mA
Charging Interface	Type-C
Charging Time	1.5 H
Battery Life	BT mode: about 47 hours (with lights off), about 35 hours (with lights on) 2.4G mode: about 42 hours (with lights off), about 32 hours (with lights on)

## 10 - Attention

Avoid using the headphone at a high volume for a long time. If tinnitus or earache occurs, please stop using.  
Do not use this product while driving a motor vehicle.  
Avoid using this product during thunderstorms or rainy weather to prevent potential product malfunctions or electrical hazards.  
Keep this product out of reach of children and pets to prevent accidental swallowing and potential choking hazards.

**Warning:** The rechargeable battery of this product must be properly handled for recycling purposes. Do not dispose of the battery in a fire, as it may cause an explosion.

**Suggestion:** It is recommended to fully charge the product once a month to maintain the battery performance of the product.

# Wireless Noise Canceling Gaming Headset