

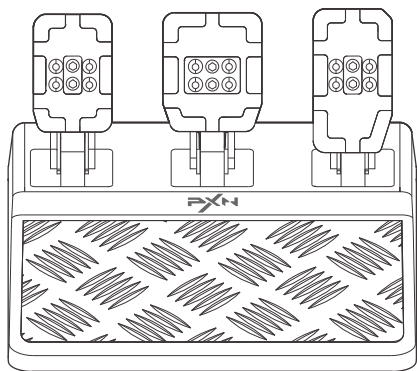

A3



USER MANUAL

For PXN Racing Wheels

- 1 Plug the Pedals into the pedals' port on racing wheel with the registered jack connector cable.
- 2 The Pedals red indicator will remain ON when connection is successful, and the Pedals can be used now.

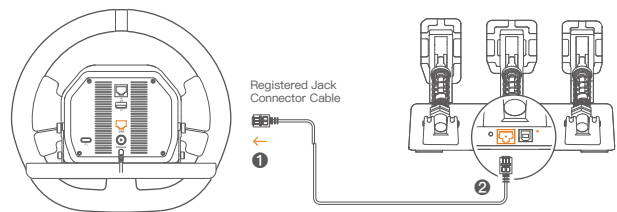

For PC

- 1 Plug the Pedals into PC USB port with the USB to USB-B cable. Plug the Pedals into PC USB port with the USB to USB-B cable.
- 2 The Pedals red indicator will remain ON when connection is successful, and the Pedals can be used now.

- 3 The value axis of Pedals correspond to clutch(X-axis)/ brake(Z-axis)/ accelerator(Y-axis).

* In the games of D-input category, the games will recognize both racing wheel and pedals separately. The pedals can be used by setting it in the games.

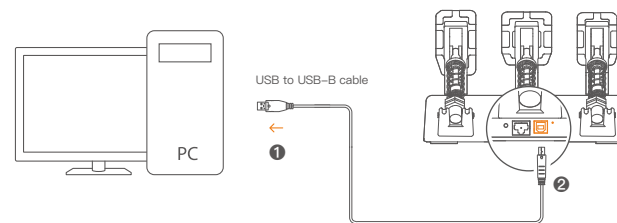

Installation

• The Pedals Angle Adjustment

- 1 Loosen and get the two Allen key screws with Allen wrench.
- 2 Adjust the Pedals in a needed position and tighten the two Allen key screws.

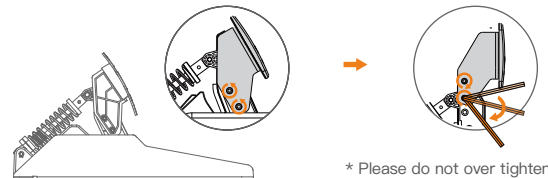

• The Pedals Strength Adjustment

- 1 Rotate the component as shown to adjust the Foot Pedals' strength. Note: Please rotate the component within screw thread.

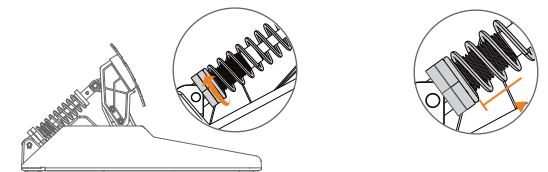

• Clamp the Pedals

- 1 There are 4 dedicated screw holes for clamping the racing wheel on stand with the screws included.

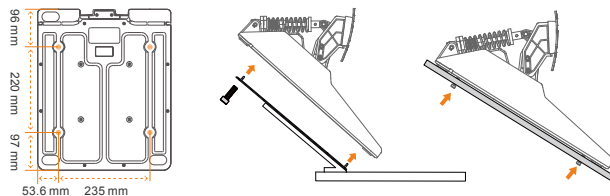

Product Accessories

- USB to USB-B cable
- Registered Jack Connector Cable
- Allen key screw*4
- Allen wrench*1

Supported Platforms

- Support Windows 7/8/10/11
- PXN Racing Wheels: PXN-V10

Product Specifications

- | | |
|---------------------|--------------|
| • Product Model | PXN-A3 |
| • Connection Method | Wired |
| • Working Voltage | 5V |
| • Working Current | ≤85mA |
| • Product Weight | About 3180 g |
| • Use Temperature | 0-40°C |
| • Use Humidity | 20-80% |

Attention

- Avoid strong vibration and gravity dropping.
- Do not disassemble, modify or repair by yourself.
- Prevent water or other liquids from entering the product to avoid damage.
- Avoid storing in humid, high temperature, oily smoke and other places.
- Please handle it gently when connect and remove the product.
- Children should be under adult's supervision at all times when using this product.